



Industrial And Commercial Energy Storage Cabinets Steel Power Supply Enclosure OEM

Our Product Introduction

for more products please visit us on power-cabinets.com

Basic Information

- Place of Origin: SHENZHEN
- Brand Name: daxin
- Certification: CE
- Model Number: ODC-210909C2T-200AH
- Minimum Order Quantity: 1 pcs
- Packaging Details: Woodcase/ Paper box
- Delivery Time: 15-25 days
- Payment Terms: T/T
- Supply Ability: 10000pcs/month



Product Specification

- Features: Commercial Power Safe, Industrial Commercial Storage, Commercial Energy Backup
- Applications: Telecommunications, Transportation, Renewable Energy, Outdoor Events
- Keywords: Outdoor Telecommunication Locker, Outdoor Telecom Enclosure, Outdoor Telecom Container
- FAQ: Brand Name: Daxin, Model Number: ODC-210909C2T-200AH, Minimum Order Quantity: 10, Payment Terms: T/T, Supply Ability: 10,000 Taiwan/month, Delivery Time: 30 Days, Packaging Details: Wooden Crate/cardboard Box
- Jacket OD: 3.0mm
- Highlight: Steel Power Supply Enclosure OEM



More Images

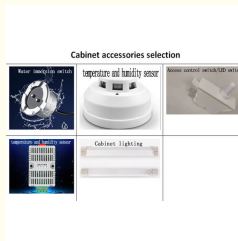

Product Description

Industrial And Commercial Energy Storage Cabinets Steel Power Supply Enclosure OEM

Energy Storage Cabinets Product Description:

The cabinets are available in two packaging options: wooden crate or cardboard box. This ensures that the cabinets are delivered safely to your

Our Product

desired destination. The wooden crate packaging is ideal for heavy-duty transportation, while the cardboard box packaging is suitable for short-distance deliveries.

Our Outdoor Telecom Cabinets offer ample storage space for all your conference room equipment needs. You can store your projectors, screens, and other conference room equipment safely in the cabinets. The cabinets are also suitable for home interior TV cabinets, offering a sleek and modern look to your living space.

Energy Storage Cabinets Features:

Product Name: Outdoor Telecom Cabinets

Price: 6000USD

Keywords:

Outdoor Telecommunication Locker

Outdoor Telecom Enclosure

Outdoor Telecom Container

Delivery Time: 30 days

Packaging:

Wooden Crate

Cardboard Box

Support and Services:

24/7 remote monitoring and diagnostics

On-site maintenance and repairs

Customized design and engineering for specific telecom equipment

Installation and commissioning services

Training for cabinet operation and maintenance

Keywords:

Conference Room Equipments

Home Interior TV Cabinet

Exterior WPC Wall Panel

Technical Parameters:

Product Name: Outdoor Telecom Enclosure Upgrade Exterior WPC Wall Panel with Outdoor Powder Coating

Product Category: Outdoor Telecom Cabinets

Price: 6000USD

Support and Services: 24/7 remote monitoring and diagnostics, On-site maintenance and repairs, Customized design and engineering for specific telecom equipment, Installation and commissioning services, Training for cabinet operation and maintenance

Features: Commercial Power Safe, Industrial Commercial Storage, Commercial Energy Backup

Energy Storage System Type: Industrial and Commercial

Jacket OD: 3.0mm

Surface Coating: Outdoor Powder Coating

Packaging: Wooden Crate or Cardboard Box

Other Accessory: Sensor

Distribution Board Enclosure,

Industrial Safety Cabinets, Cabinet

Data Center

Applications:

The outdoor telecom cabinet is designed to withstand harsh weather conditions and protect the enclosed electronic equipment. The cabinet is made of high-quality materials that are resistant to corrosion, dust, and water. The upgrade exterior WPC wall panel provides additional protection against the elements, and the outdoor powder coating ensures that the cabinet is long-lasting and durable.

The Daxin outdoor telecom cabinet is versatile and can be used in various scenarios. It is suitable for home interior TV cabinets, data rack cabinets, and fresh air cabinets. The cabinet is also ideal for use in outdoor environments such as telecommunication base stations, power distribution systems, and transportation systems.

The cabinet is easy to install and maintain, making it an excellent choice for both indoor and outdoor applications. The wooden crate or cardboard box packaging ensures that the product arrives at the destination in excellent condition. The Daxin outdoor telecom cabinet is a high-quality product that is backed by a reputable manufacturer.

Support and Services:

Our Outdoor Telecom Cabinets are designed to provide reliable and secure protection for your telecom equipment in harsh outdoor environments.

Our technical support team is available to assist you with any questions or issues you may encounter with your Outdoor Telecom Cabinet, including:

Installation assistance

Troubleshooting

Maintenance and repair

Upgrades and modifications

In addition, we offer a range of services to ensure the optimal performance and longevity of your Outdoor Telecom Cabinet, including:

Regular maintenance and cleaning

Environmental testing

Security and access control

Equipment replacement and upgrades

Our goal is to provide you with the highest level of support and service possible, so you can trust that your telecom equipment is always protected and functioning at its best.

Packing and Shipping:

Product Packaging:

Our Outdoor Telecom Cabinets are carefully packaged to ensure safe delivery. They are wrapped in protective material and placed in sturdy cardboard boxes.

Shipping:

We offer worldwide shipping for our Outdoor Telecom Cabinets. Shipping costs vary depending on the destination and the size of the order. Delivery times will also vary depending on the destination, but we aim to dispatch all orders within 2-3 business days.

FAQ:

Q: What is the brand name of this product?

A: The brand name of this product is daxin.

Q: What is the model number of this product?

A: The model number of this product is ODC-210909C2T-200AH.

Q: Is this product certified?

A: Yes, this product is CE certified.

Q: Where is this product manufactured?

A: This product is manufactured in SHENZHEN.

Q: What is the minimum order quantity for this product?

A: The minimum order quantity for this product is 10 units.

Q: What is the price of this product?

A: The price of this product is 6000 USD.

Q: What are the payment terms for purchasing this product?

A: The payment terms for purchasing this product are T/T.

Q: What is the supply ability of this product?

A: The supply ability of this product is 10,000 units per month from Taiwan.

Q: What is the delivery time for this product?

A: The delivery time for this product is 30 days.

Q: How is this product packaged?

A: This product is packaged in a wooden crate or cardboard box.



Product list

Number	Name/Description	Specification/Model	Parameter
1	Outdoor integrated power cabinet	900*900*2150	A. Cabinet dimensions: W × D×H900 * 900 * 2150mm; Internal dimensions: W × D×H800 * 800 * 1800mm B. Cabinet composition: cabinet body+cabinet door+base+top cover+rack+battery layer board+cabinet lock C. Cabinet type: 1 unit, 1 compartment, front door, floor mounted D. Cabinet material: 1.5mm galvanized sheet; E. Thermal insulation performance: thermal conductivity<0.472W/(m2.k); F. Upper equipment rack: 19 inch rack, 22U, 3 pairs of support bars, 1 pallet; The lower two battery racks can accommodate up to 2 sets of 48200AH lead-acid batteries; G. Cabinet base: 100mm high, 2.0mm thick; H. Entry method: Bottom in and bottom out with a diameter of 50 * 4; I. Anti theft design: embedded doors, embedded links, point type anti-theft locks; J. Protection level: IP65; K. Color: RAL7035, professional outdoor powder coating; L. Screen printing of cabinet with "Danger of Electricity" label; M. Including grounding copper bar, LED light, door magnetic switch, and cooling fan (optional)
2	Embedded switch power supply 200A	ET-PS48200Z-6U	Standard 19 inches, embedded plug-in frame 3U high; AC input 220V, DC output 48V; Equipped with 3 30A rectifier modules and 1 monitoring and management module; Capable of battery charging management; Distribution section: AC input: air switch D247-63/2P C63 63A/2P * 1; Three phase AC C-level lightning arrester 20-40KA; Communication output: Air switch D247-63/2 C32 32A/2P * 1; Ground wire terminal * 1; DC C-level lightning arrester 20-40KA 1P * 1; DC output: One power outage: D247-63/1 C63 63A/1P * 3, Secondary power off: D247-63/1 C63 63A/1P * 3 Battery empty switch: D247-125/1 125A/1P * 2.
3	Distribution unit (optional/customizable)	3U	19 inch 3U high embedded plug-in frame, AC380V input, 63A/4P × 2 (AC input, oil engine input+mechanical interlock plate), three-phase B-class lightning arrester × 1, 63A/3P × 1, 32A/1P × 2, 16A/1P × 2, 10A/1P × 1, 6A/1P × 1, three hole maintenance socket × 1, ground row × 1, zero row × 1.
4	Lithium battery/lead-acid battery (optional)	8u 100AH	48V 100AH
5	FSU	1U	8 RS485 serial ports, 8 DI inputs, 4 DO dry contact outputs, 1 mains power status detection input, 1 water immersion detection input, 1 built-in vibration sensor, 1 USB interface, 1 RJ45 IP port, 1 console debugging port, port lightning and surge protection. The software comes with a web management interface, which allows for the configuration of the collector through a web browser, as well as the viewing of real-time collected data, alarms, and controls. Historical data and alarms can also be queried; Support centralized monitoring through SNMP or B interface access to the backend monitoring system.
6	Camera	2 million infrared hemisphere	
7	UPS	3KVA	
8	Communication air conditioning	1500W	AC 220V



*Main equipment for cabinet processing
(Three main equipment)*



Laser



TRUMATIC500- Fully Automatic



TRUMATIC500- Fully Automatic
Japan AMADA - Fully Automatic

- 1500W: 1tower
- 3000W: 2tower

- Fast data punching: 4 u
nits with automatic loadin
g and unloading

- Japan AMADA: 7 units wi
th automatic loading and
unloading
- Model: EW-2510NT/AC-25
10NT

Key process - general punching, ben ding, and riveting workshop



- Japan AMADA: 25 uni
ts
- Model: RG-35S



- TOX riveting m
achine: 24 units



- Puchong: 5 units
(160T+250T+300T)



Key Process - Copper and Aluminum Product Workshop (Integrat ed Cutting and Punching Machine)



- Copper bar integrated
machine: 2 units
- Model: LID-30
- Features: high-precisi
on automatic cutting and
punching



Key Process - Welding Workshop



Fully automatic, 360 degree rotating welding line features: Welding accuracy: Welding displacement less than 1.5 mm, welding flip angle less than 0.1 degrees. Welding software: Our self-developed welding control software v1.3 version can store up to 128 welding programs. Scan the product code to initiate the welding program, automatically switch between dual platforms, seamlessly connect, and achieve uninterrupted welding. Welding dimensions: Product height 2.8 meters, width 1.5 meters. Welding capacity: 11 fully automatic welding robots and 47 welders. Monthly output of 20000 to 25000 cabinets.

Key Process - Polishing Workshop

- Automatic polishing machine: 2 units, equipment can be increased according to product demand.
- Manual polishing stations: 15, with manpower allocated according to the product structure.

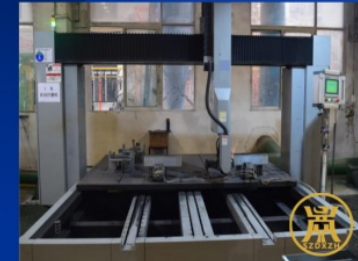

Key Process - Metal Surface Treatment (Fully Automated)

Surface treatment line 1 (parts category)



Surface treatment 2-wire (cabinet type)



Surface treatment 2-wire (cabinet type):

- Full-process foolproofing: Unmanned operation, the system automatically performs surface treatment according to predefined process paths based on different materials, eliminating quality risks caused by human errors.
- Continuous monitoring: The system continuously monitors the pH level of the solution and automatically initiates the addition of the solution based on the monitoring results.
- Monthly capacity: Over 20,000 large cabinets

Key process - Metal parts electroplating workshop (automated assembly line)



Key process - Spray painting workshop (3 main lines+1 auxiliary line/small batch)

Reciprocating machine (automatic powder spraying)



Automatic Line 1



Characteristics of Spray Line:

- ◆ Characteristics of Spray Line: The system monitors the furnace temperature in real-time, and when the oven temperature does not meet the standard, the system monitors the furnace temperature in real-time, and when the oven temperature does not meet the standard.
- ◆ Automatic spraying: Reciprocating machine automatic spraying ensures uniform thickness and aesthetic appearance of the coating.
- ◆ Equipment resources: 3 main lines+1 auxiliary line, which can simultaneously meet the needs of different colors.
- ◆ Daily production capacity: 15,000 to 20,000 square meters per day.



Automatic Line 2



Automatic Line 3

Key Process - Product Assembly Workshop



Large cabinet assembly line



Small cabinet with assembly line



IPX6 Spray Water Testing System



Small chassis wiring assembly line



Outdoor cabinet product assembly line



High voltage product assembly line

Key process - outdoor cabinet waterproof testing assembly line

- Pipeline standard: IPX1-IPX5 waterproof rating, which can be adjusted and matched according to product requirements.



Trial water process diagram



Test water



Shenzhen Daxin Intelligent Equipment Technology Co., Ltd.

Shenzhen Daxin Intelligent Equipment Technology Co., Ltd



+86 15817363697



lubenzhi@szdxzh.com



power-cabinets.com

Green Base Industrial Park, Longtian Street, Pingshan District, Shenzhen