



## All In On Bess / Ess Solar Storagey System 50kva 100kwh Solar Pv Batteries Solution

Our Product Introduction

### Basic Information

- Place of Origin: CHINA
- Brand Name: Daxin
- Certification: /
- Model Number: DX-BESS-50K100
- Minimum Order Quantity: 1 Set
- Packaging Details: Wooden case with pallet
- Delivery Time: 25-35 days
- Payment Terms: T/T
- Supply Ability: 6000pcs/month



### Product Specification

- System Configuration: Outdoor Cabinet+Inverter+Battery
- Cabinet Lock: Anti-theft Three Point Lock
- Protection Level: IP55
- Power Output: Varies Depending On Customer Needs
- Cabinet Material: Galvanized Steel
- Highlight: 50kva Solar Pv Batteries,  
Ess Solar Storagey System,  
100kwh Solar Pv Batteries



for more products please visit us on [power-cabinets.com](http://power-cabinets.com)

## Product Description

### All In On Bess / Ess Solar Storagey System 50kva 100kwh Solar Pv Batteries Solution

#### Industrial And Commercial Energy Storage System Introduction

The DX-BESS-50K100 is an innovative and advanced solar PV batteries solution crafted by DX ENERGY, a leading manufacturer in the field. It harnesses high-voltage lithium iron phosphate (LiFePO4) battery technology to offer a reliable, efficient, and safe renewable energy storage and backup power solution. This modular system is designed for large-scale applications, ensuring seamless operation in diverse scenarios.

#### Industrial And Commercial Energy Storage System Parameters:

System Specification	
Nominal Output Power/UPS Power(W)	50000
AC Output Frequency and Voltage	50/60Hz;3LN/PE220/380,230/400Vac
Grid Type	Threephase
Energy Configuration (kWh)	102.4
Dimension (WxDxH,mm)	1400x1100x1650(nocontaininverter)
Weight Appr.(kg)	1350(nocontaininverter)
AC Output Rated Current(A)	75.8
Battery Operating Voltage(V)	400~800
Battery Chemistry	LiFePO4
IP Rating of Enclosure	IP55
System Certification	UN38.3,IEC62619,CE,CEI0-21,VDE-AR-N4105,IEC62109

#### Inverter Technical Parameters:

Max Parallel connection sets	10
Max.PV Input Power (W)	65000
Max.PV Input Current(A)	36+36+36+36
Rated PV Input Voltage(Vdc)	600
Start Up DC Voltage(Vdc)	180
MPPT Voltage Range (Vdc)	150-850
Max.PV Short-circuit Current(A)	55+55+55+55
Number of MPPT	4
Peak Power(off grid)	1.5 time of rated power,10s
Power Factor	0.8 leading to 0.8 lagging
THD	<3%
DC injection current(Ma)	<0.5In
Display	LCD
Operating Temperature Range(°C)	-40-60(>45°C derating)
Relative Humidity	15%~85%(No Condensing)
Dimension (WxDxH,mm)	527x294x894
Inverter Communication	CAN,RS485,WIFI,ETH
Safety EMC/Standard	IEC/EN 62109-1,IEC/EN62109-2,IEC/EN 61000-6-1,IEC/EN 61000-6-2,IEC/EN 61000-6-3,IEC/EN 61000-6-4
Grid Regulation	VDE4105,IEC61727/62116,VDE0126 AS4777.2,CEI021,EN50549-1,G98,G99, C10-11,UNE217002,NBR16149/NBR16150
Max.Efficiency	97.6%
Max.charging/discharging efficiency	91%

#### Industrial And Commercial Energy Storage System Advantages

**Intelligent Temperature Control:** A built-in air conditioner ensures the battery temperature remains below 40°C, optimizing performance and battery lifespan.

**Reliable:** The Positive Balance Intelligent BMS provides comprehensive protection, effectively extending the cycle life of battery packs.

**Flexible:** With the integration of EMS and BMS technologies, AC/DC power supply redundancy design, and support for the black start function, it offers great flexibility in operation.

**Safer:** Using Prismatic Lithium Iron Phosphate (LFP) Battery, the battery pack and system adopt an aerosol fire extinguishing solution, enhancing safety.

### Industrial And Commercial Energy Storage System Uses

**Renewable Energy Storage:** Ideal for storing energy generated from solar PV systems, enabling efficient utilization of renewable energy.

**Backup Power:** Serves as a reliable backup power source during power outages, ensuring continuous operation of critical loads.

**Grid Support:** Can be used in grid-connected applications to support grid stability and power quality improvement.

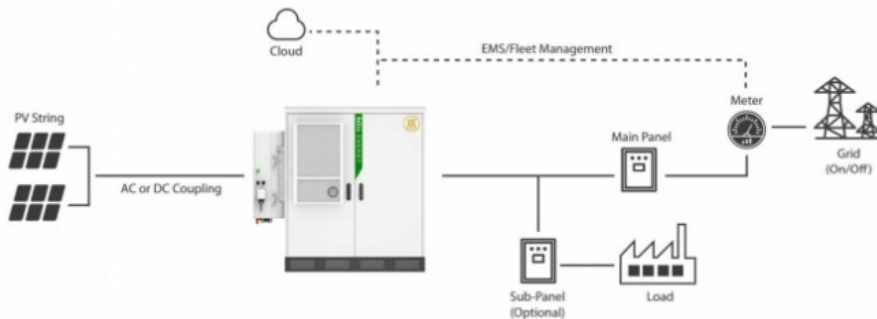

### Industrial And Commercial Energy Storage System Features

**Modular Design:** Composed of 10 battery modules (10.24KWH each) connected in series, providing a total usable capacity of 100kWh.

**Eco-friendly:** With cobalt-free, non-toxic LiFePO<sub>4</sub> chemistry and an IP55 enclosure, it allows for versatile indoor or outdoor installation, being environmentally friendly.

**Integrated Management Systems:** The integrated energy management system supports functions like black start and AC/DC coupling with solar PV, while the intelligent battery management system monitors and protects each module.



**Shenzhen Daxin Intelligent Equipment Technology Co., Ltd**



+86 15817363697



lubenzhi@szdxzh.com



power-cabinets.com

Green Base Industrial Park, Longtian Street, Pingshan District, Shenzhen